

S722C Vibration monitor adjustable ISO10816



Overview

- Vibration sensor according to ISO 10816 with M12 connector and LED display
- Vibration measuring range 0...25 mm/s (RMS)
- Frequency range 10...1000 Hz
- Protection rating IP67
- Analogue output, 1x normally closed

In daily use - proven millions of times over. Products from autosen are under highest quality requirements regarding robustness, insensitivity and reliability. We offer 5 years warranty - with money-back guarantee!

Dimensional drawing

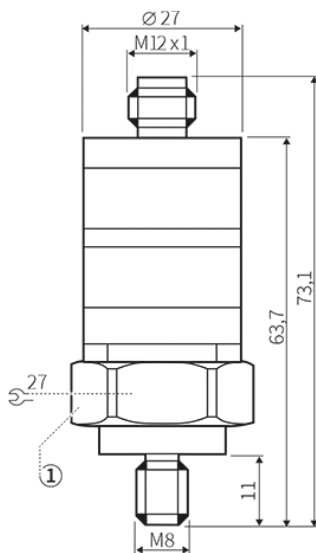

Dimensional drawing legend

- 1: tightening torque 15 Nm M8 standard thread
1.25 mm pitch

Connection & pin assignment

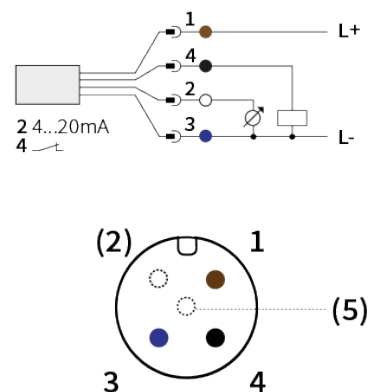

General information

Frequency range	10...1000 Hz
Vibration measuring range	0...25 mm/s (RMS)
Number of measuring axes	1
Delay time adjustable	1 ... 60 s

Outputs / inputs

Switching output	Normally closed (NC)
Analogue output	4 ... 20 mA
Comment on analogue output	When used with an analog output use exclusively sensor cables without LED

Electrical data

Operating voltage	18 ... 32 V DC
Voltage type	Direct voltage (DC)
Electrical design	PNP
Current carrying capacity max.	500mA
Voltage drop max.	2V
Current consumption max.	50mA
Protection class	III
Short-circuit protection	Yes
Overload-proof	Yes
Reverse polarity protection	Yes

Mechanical data

Type of installation	Threaded pin
Structural length	73.1 mm
Material of housing	PBT V4A (1.4404) PC Viton
Electrical connection	M12 4-pin Contacts gold-plated

Accuracy

Reproducibility	< 0.5% of final value
Switching point accuracy	< ±4 % of end value
Linearity deviation	0.25 %
Measuring error	< ± 3 % of final value

Ambient conditions

Ambient temperature min.	-30°C
Ambient temperature max.	125°C
Information regarding ambient temperature	UL application: < 80 °C
Protection rating	IP67

Additional information

MTTF	510years
Function display	LED Yellow Green
Accessories included with delivery	No accessories included
EMC test	DIN EN 61000-4-2 ESD DIN EN 61000-4-3 HF radiated DIN EN 61000-4-4 burst DIN EN 61000-4-6 HF grid-bound
Adjusting ring	Switching point compensation Switching delay
Approval	CE cULus